

**Bareshaft Construction with Mechanical Seal**

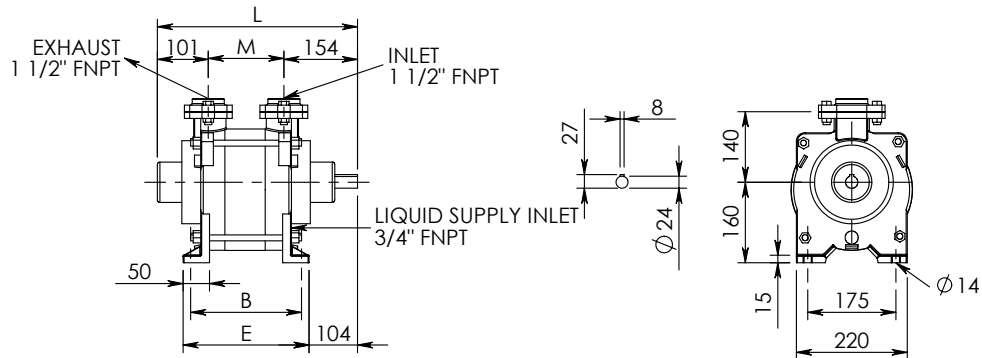

| Pump Type     | B   | E   | M   | L   | Weight (Kg.) |
|---------------|-----|-----|-----|-----|--------------|
| TRSE 40-55/C  | 180 | 210 | 110 | 365 | 34           |
| TRSE 40-100/C | 220 | 250 | 150 | 405 | 39           |
| TRSE 40-150/C | 250 | 280 | 180 | 435 | 44           |

**Closed-Coupled Construction with Mechanical Seal**

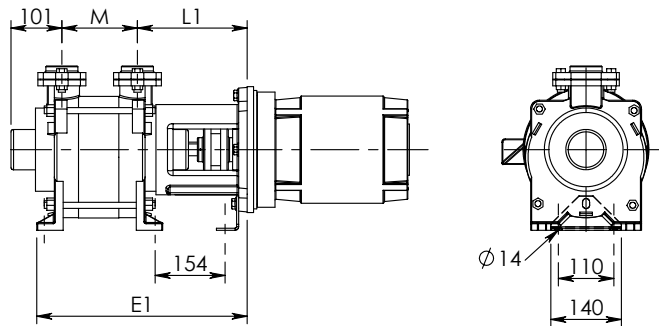

| Pump Type     | 4 Poles Motor HP | Pump |     |     | Weight <sup>1</sup> (Kg.) |
|---------------|------------------|------|-----|-----|---------------------------|
|               |                  | E1   | M   | L1  |                           |
| TRSE 40-55/C  | 3                | 390  | 110 | 230 | 47                        |
|               | 5                |      |     |     | 52                        |
| TRSE 40-100/C | 5                | 430  | 150 | 251 | 57                        |
|               | 7½               | 451  |     |     |                           |
| TRSE 40-150/C | 5                | 460  | 180 | 230 | 63                        |
|               | 7½               | 481  |     | 251 |                           |

**Base-Mounted Construction (Baseplate-Coupling) with Mechanical Seal**

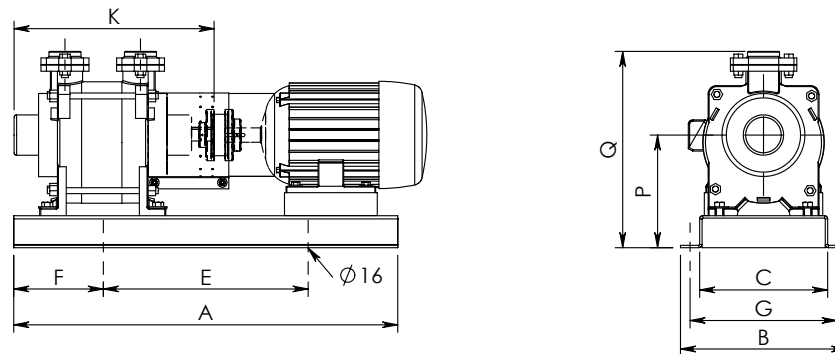

| Pump Type     | 4 Poles Motor HP | Base Plate | Pump |     |     |     |     |     |     |     |     |     | Weight <sup>1</sup> (Kg.) |
|---------------|------------------|------------|------|-----|-----|-----|-----|-----|-----|-----|-----|-----|---------------------------|
|               |                  |            | A    | B   | C   | D   | E   | F   | G   | K   | P   | Q   |                           |
| TRSE 40-55/C  | 3                | 901        | 770  | 350 | 290 | 65  | 420 | 175 | 320 | 365 | 220 | 376 | 59                        |
|               | 5                |            |      |     |     | 90  |     |     |     |     |     |     |                           |
| TRSE 40-100/C | 5                | 900        | 960  | 370 | 310 | 30  | 600 | 180 | 340 | 405 | 225 | 381 | 64                        |
|               | 7½               |            |      |     |     | 30  |     |     |     |     |     |     |                           |
| TRSE 40-150/C | 5                | 901        | 770  | 350 | 290 | 100 | 420 | 175 | 320 |     | 220 | 376 | 69                        |
|               | 7½               | 900        | 960  | 370 | 310 | 45  | 600 | 180 | 340 | 435 | 225 | 381 | 82                        |

<sup>1</sup> Weight without motor  
The weights are referred to GH construction  
Dimensions in mm

